

Pignoni temperati ad induzione sui denti (45 ÷ 55 HRC)
Sprockets with hardened teeth (45 ÷ 55 HRC)
Kettenräder mit ind. gehärteter Verzahnung (45 ÷ 55 HRC)
Pignons avec denture trempee haute frequence (45 ÷ 55 HRC)
Piñones templados por inducción en los dientes (45 ÷ 55 HRC)

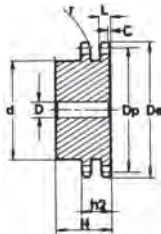
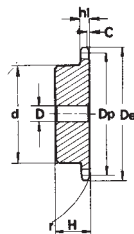

PIÑONES	ISO mm
Radio diente r	r 26,0
Ancho radio C	C 2,5
Ancho diente h ₁	h ₁ 16,2
Ancho diente L	L 15,8
Ancho diente h ₂	h ₂ 47,7

Materiale C45E
UNI EN 10083-1

Material C45E
UNI EN 10083-1

Werkstoff C45E
UNI EN 10083-1

PIÑONES	ISO mm
Radio diente r	r 32,0
Ancho radio C	C 3,5
Ancho diente h ₁	h ₁ 18,5
Ancho diente L	L 18,2
Ancho diente h ₂	h ₂ 54,6

Matière C45E
UNI EN 10083-1

Material C45E
UNI EN 10083-1

1" x 17,02 mm 16B - 1 - 2 25,4 x 17,02 mm

Z	D _e	D _p	Simplex			Duplex				
			cod.	d	D	H	cod.	d	D	H
8	77,0	66,37	20082008TI	42	16	35	22082008TI	42	16	65
9	85,0	74,27	20082009TI	50	16	35	22082009TI	50	16	65
10	93,0	82,19	20082010TI	55	16	35	22082010TI	56	16	65
11	99,5	90,14	20082011TI	61	16	40	22082011TI	64	20	70
12	109,0	98,14	20082012TI	69	16	40	22082012TI	72	20	70
13	117,0	106,12	20082013TI	78	16	40	22082013TI	80	20	70
14	125,0	114,15	20082014TI	84	16	40	22082014TI	88	20	70
15	133,0	122,17	20082015TI	92	16	40	22082015TI	96	20	70
16	141,0	130,20	20082016TI	100	20	45	22082016TI	104	20	70
17	149,0	138,22	20082017TI	100	20	45	22082017TI	112	20	70
18	157,0	146,28	20082018TI	100	20	45	22082018TI	120	20	70
19	165,2	154,33	20082019TI	100	20	45	22082019TI	128	20	70
20	173,2	162,38	20082020TI	100	20	45	22082020TI	130	20	70
21	181,2	170,43	20082021TI	110	20	50	22082021TI	130	25	70
22	189,3	178,48	20082022TI	110	20	50	22082022TI	130*	25	70
23	197,5	186,53	20082023TI	110	20	50	22082023TI	130*	25	70
24	205,5	194,59	20082024TI	110	20	50	22082024TI	130*	25	70
25	213,5	202,66	20082025TI	110	20	50	22082025TI	130*	25	70
26	221,6	210,72	20082026TI	120	20	50	22082026TI	130*	25	70
27	229,6	218,79	20082027TI	120	20	50	22082027TI	130*	25	70
28	237,7	226,85	20082028TI	120	20	50	22082028TI	130*	25	70
30	254,0	243,00	20082030TI	120	20	50	22082030TI	130*	25	70
32	270,0	259,13	20082032TI	120*	25	50	22082032TI	140*	25	70
34	287,0	275,28	20082034TI	120*	25	50	22082034TI	140*	25	70
35	296,2	283,36	20082035TI	120*	25	50	22082035TI	140*	25	70
36	304,6	291,44	20082036TI	120*	25	50	22082036TI	140*	25	70
38	320,7	307,59	20082038TI	120*	25	50	22082038TI	140*	25	70
40	336,9	323,73	20082040TI	120*	25	50	22082040TI	140*	25	70

1" 1/4 x 3/4" 20B - 1 - 2 31,75 x 19,56 mm

Z	D _e	D _p	Simplex			Duplex				
			cod.	d	D	H	cod.	d	D	H
8	98,1	82,96	20102008TI	53	20	40	22102008TI	53	20	75
9	108,0	92,84	20102009TI	63	20	40	22102009TI	63	20	75
10	117,9	102,74	20102010TI	70	20	40	22102010TI	70	20	75
11	127,8	112,68	20102011TI	77	20	45	22102011TI	80	20	80
12	137,8	122,68	20102012TI	88	20	45	22102012TI	90	20	80
13	147,8	132,65	20102013TI	98	20	45	22102013TI	100	20	80
14	157,8	142,68	20102014TI	108	20	45	22102014TI	110	20	80
15	167,9	152,72	20102015TI	118	20	45	22102015TI	120	20	80
16	177,9	162,75	20102016TI	120	25	50	22102016TI	120	25	80
17	187,9	172,78	20102017TI	120	25	50	22102017TI	120	25	80
18	198,0	182,85	20102018TI	120	25	50	22102018TI	120*	25	80
19	208,1	192,91	20102019TI	120	25	50	22102019TI	120*	25	80
20	218,1	202,98	20102020TI	120	25	50	22102020TI	120*	25	80
21	228,2	213,04	20102021TI	140	25	55	22102021TI	140*	25	80
22	238,3	223,11	20102022TI	140	25	55	22102022TI	140*	25	80
23	248,3	233,17	20102023TI	140	25	55	22102023TI	140*	25	80
24	258,4	243,23	20102024TI	140	25	55	22102024TI	140*	25	80
25	268,5	253,33	20102025TI	140	25	55	22102025TI	140*	25	80
26	278,6	263,40	20102026TI	150*	25	55	22102026TI	150*	25	80
27	288,6	273,48	20102027TI	150*	25	55	22102027TI	150*	25	80
28	298,7	283,56	20102028TI	150*	25	55	22102028TI	150*	25	80
30	318,9	303,75	20102030TI	150*	25	55	22102030TI	150*	25	80
32	339,1	323,91	20102032TI	150*	25	55	22102032TI	150*	25	80
34	359,3	334,10	20102034TI	150*	25	55	22102034TI	150*	25	80
35	369,4	354,20	20102035TI	150*	25	55	22102035TI	150*	25	80
36	379,5	364,30	20102036TI	150*	25	55	22102036TI	150*	30	80
38	399,6	384,49	20102038TI	150*	25	55	22102038TI	150*	30	80
40	419,8	404,66	20102040TI	150*	25	55	22102040TI	150*	30	80