

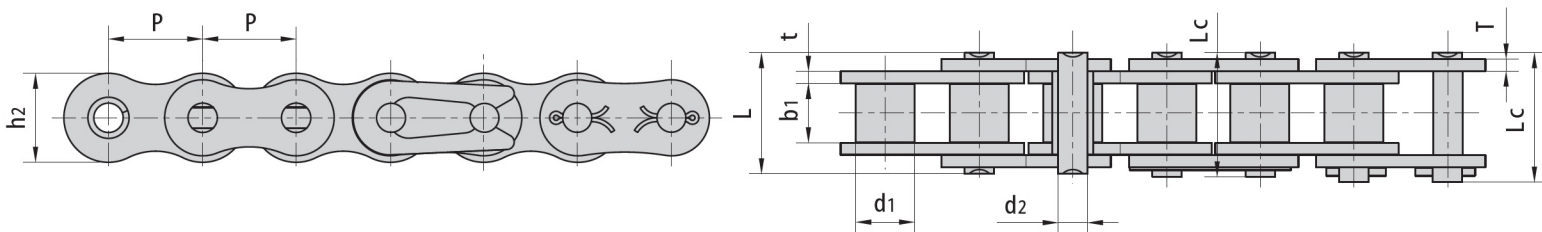

# Cadenas resistentes a la corrosión / niqueladas

## Corrosion resistant/Nickel-plated chains

### Chaînes nickelées résistant à la corrosion



Codigo Code	Referencia Reference Référence	Paso Pitch Pas	∅ Rodillo Roller Roleau	Ancho interior Width inner Largeur intérieur	∅ Eje Pin Rouleau	Longitud eje Pin length Longueur axe		Ancho de malla Inner plate depth Largeur plaques	Espesor de malla Plate thickness Épaisseur plaques	Peso por metro Weight per meter Poids par mètre
		P	d1 max	b1 min	d2 max	L max	Lc max	h2 max	T max	q
		mm	mm	mm	mm	mm	mm	mm	mm	Kg/m
	25NP	6.350	3.30	3.18	2.31	7.90	8.40	6.00	0.80	0.15
	35NP	9.525	5.08	4.77	3.58	12.40	13.17	9.00	1.30	0.33
	41NP	12.700	7.77	6.25	3.58	13.75	15.00	9.91	1.30	0.41
	40NP	12.700	7.95	7.85	3.96	16.60	17.80	12.00	1.50	0.62
	50NP	15.875	10.16	9.40	5.08	20.70	22.20	15.09	2.03	1.02
	60NP	19.050	11.91	12.57	5.94	25.90	27.70	18.00	2.42	1.50
	80NP	25.400	15.88	15.75	7.92	32.70	35.00	24.00	3.25	2.60
	100NP	31.750	19.05	18.90	9.53	40.40	44.70	30.00	4.00	3.91
	120NP	38.100	22.23	25.22	11.10	50.30	54.30	35.70	4.80	5.62
	140NP	44.450	25.40	25.22	12.70	54.40	59.00	41.00	5.60	7.50
	160NP	50.800	28.58	31.55	14.27	64.80	69.60	47.80	6.40	10.10
	04BNP	6.000	4.00	2.80	1.85	6.80	7.80	5.00	0.60	0.11
	05BNP	8.000	5.00	3.00	2.31	8.20	8.90	7.10	0.80	0.20
10032099	06BNP	9.525	6.35	5.72	3.28	13.15	14.10	8.20	1.30	0.41
10042099	08BNP	12.700	8.51	7.75	4.45	16.70	18.20	11.80	1.60	0.69
10052099	10BNP	15.875	10.16	9.65	5.08	19.50	20.90	14.70	1.70	0.93
10062099	12BNP	19.050	12.07	11.68	5.72	22.50	24.20	16.00	1.85	1.15
10082099	16BNP	25.400	15.88	17.02	8.28	36.10	37.40	21.00	4.15/3.1	2.71
10102099	20BNP	31.750	19.05	19.56	10.19	41.30	45.00	26.40	4.5/3.5	3.70
	24BNP	38.100	25.40	25.40	14.63	53.40	57.80	33.20	6.0/4.8	7.10
	28BNP	44.450	27.94	30.99	15.90	65.10	69.50	36.70	7.5/6.0	8.50
	32BNP	50.800	29.21	30.99	17.81	66.00	71.00	42.00	7.0/6.0	10.25