

Cadenas de rodillos doble DIN 8187 Serie europea Double roller chains DIN 8187 European series Chaînes à rouleaux doubles DIN 8187 série européenne

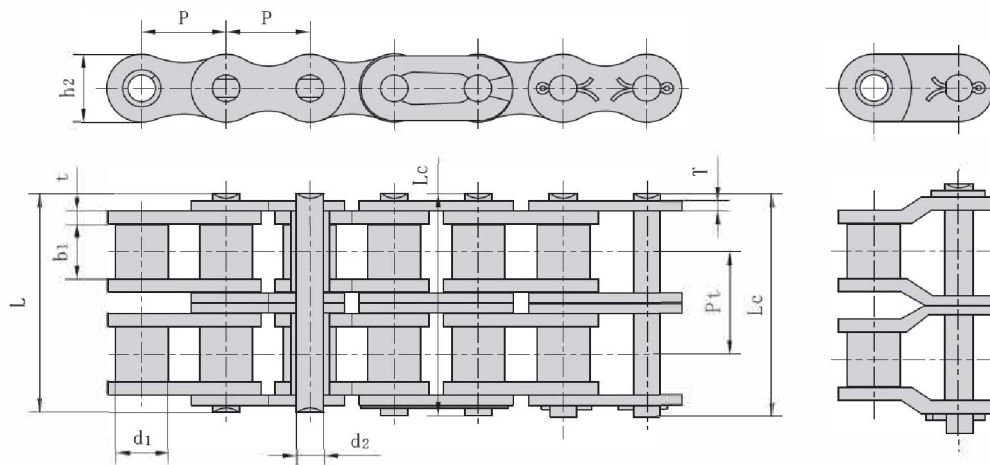

Codigo Code	Referencia Reference Référence	Paso Pitch Pas	Ø Rodillo Roller Rouleau		Ancho interior Width inner Largeur intérieur	Ø Eje Pin Rouleau		Longitud eje Pin length Longueur axe	Ancho de malla inner plate depth Largeur plaques	Espesor de malla Plate thickness Épaisseur plaques	Médula transversal Transversale pith Moelle transversale	Carga de rotura Breaking load Charge rupture	Peso por metro Weight per meter Poids par mètre
			d 1 max mm	b 1 min mm		d 2 max mm	L max mm						
12028050	05B-2	8.000	5.00	3.00	2.31	13.9	14.5	7.10	0.80	5.64	7.8/1773	0.33	
12032050	*06B-2	9.525	6.35	5.72	3.28	23.4	24.4	8.20	1.30	10.24	16.9/3841	0.77	
12042050	08B-2	12.700	8.51	7.75	4.45	31.0	32.2	11.80	1.60	13.92	32.0/7273	1.34	
12052050	10B-2	15.875	10.16	9.65	5.08	36.1	37.5	14.70	1.70	16.59	44.5/10114	1.84	
12062050	12B-2	19.050	12.07	11.68	5.72	42.0	43.6	16.00	1.85	19.46	57.8/13136	2.31	
12082050	16B-2	25.400	15.88	17.02	8.28	68.0	69.3	21.00	4.15/3.1	31.88	106.0/24091	5.42	
12102050	20B-2	31.750	19.05	19.56	10.19	77.8	81.5	26.40	4.50/3.5	36.45	170.0/38636	7.20	
12122050	24B-2	38.100	25.40	25.40	14.63	101.7	106.2	33.20	6.00/4.8	48.36	280.0/63636	13.40	
12142050	28B-2	44.450	27.94	30.99	15.90	124.6	129.1	36.70	7.50/6.0	59.56	360.0/81818	16.60	
12162050	32B-2	50.800	29.21	30.99	17.81	124.6	129.6	42.00	7.00/6.0	58.55	450.0/102273	21.00	
12202050	40B-2	63.500	39.37	38.10	22.89	154.5	161.5	52.96	8.50/8.0	72.29	630.0/143182	32.00	
12242050	48B-2	76.200	48.26	45.72	29.24	190.4	198.2	63.80	12.00/10.0	91.21	1000.0/227272	50.00	
12282050	56B-2	88.900	53.98	53.34	34.32	221.2	229.6	77.80	13.50/12.0	106.60	1600.0/363635	71.48	
	64B-2	101.600	63.50	60.96	39.40	249.9	258.4	90.17	15.00/13.0	119.89	2000.0/454544	91.00	
	72B-2	114.300	72.39	68.58	44.48	283.7	292.7	103.60	17.00/15.0	136.27	2500.0/568180	120.40	

* Malla recta / Straight Plates / Plaques droites