

Tipo / Type  
3F

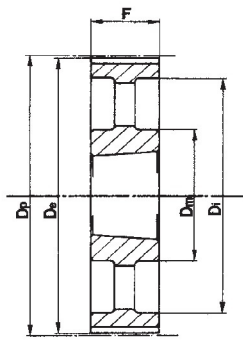

Tipo / Type  
3A

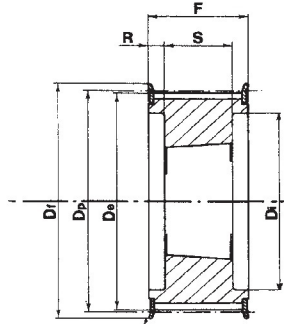

Tipo / Type  
4F

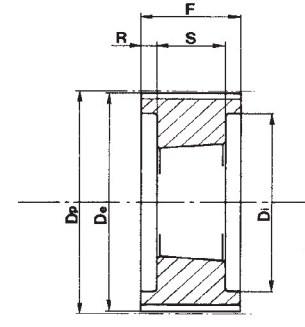

Tipo / Type  
4

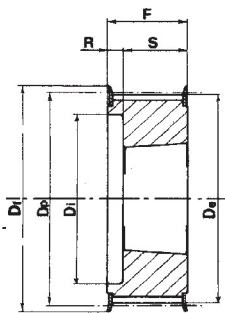

Tipo / Type  
5F

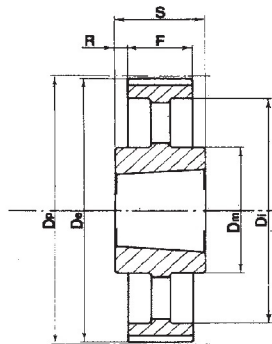

Tipo / Type  
7A

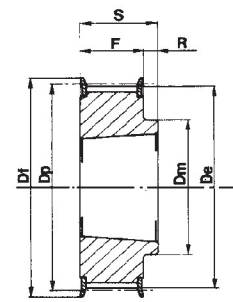

Tipo / Type  
8F

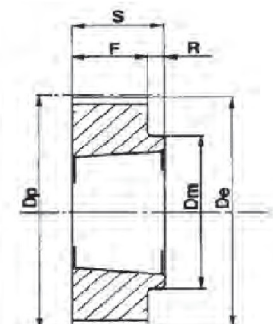

Tipo / Type  
8

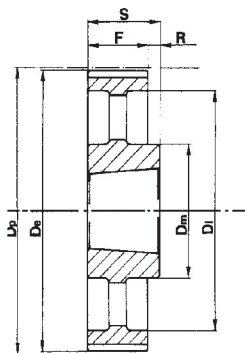

Tipo / Type  
8A

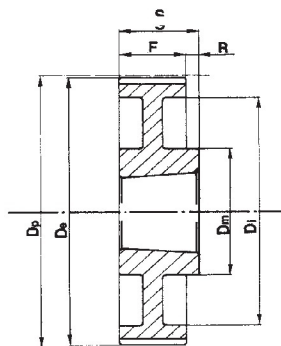

Tipo / Type  
8W

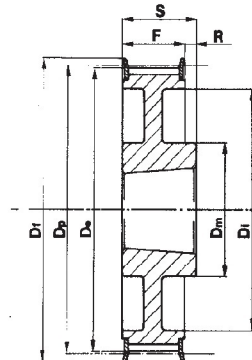

Tipo / Type  
8WF

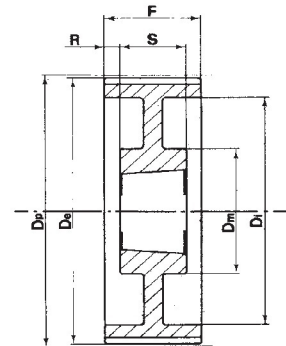

Tipo / Type  
9W

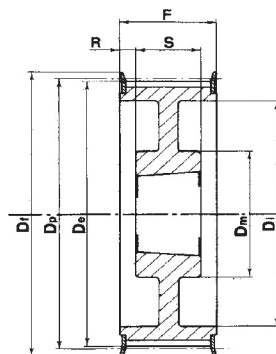

Tipo / Type  
9WF

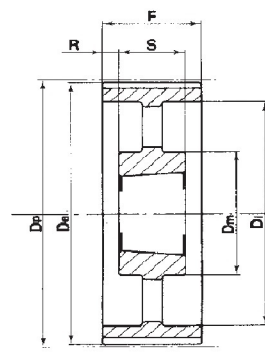

Tipo / Type  
9A



## HTD® 8M-20

| Caratteristiche<br>Features<br>Merkmale<br>Características | Codice<br>Code symbol<br>Bezeichnung<br>Code symbole<br>Numero de fabrica        | Nostro codice<br>Our code<br>Unser Code<br>Notre code<br>Nuestro codigo | Tipo<br>Type<br>Typ<br>Type<br>Tipo | Codice flangia<br>Flange code<br>Bordscheiben Typ<br>Code flasque<br>Código brida | Bussola<br>Bush<br>Buchse<br>Moyeu<br>Casquillo | Foro max.<br>Max. Bore<br>Max. Bohrung<br>Alesage max.<br>Agujero max. | Dp     | De     | Df     | Dm    | Di  | F   | S  | R    | Peso<br>Weight / Gewicht<br>Poids / Peso<br>Kg |      |
|--|--|---|-------------------------------------|---|---|--|--------|--------|--------|-------|-----|-----|----|------|--|------|
| Acciaio / Steel / Stahl<br>Acier / Acero                   | con flangia / with flanges<br>mit Flanges / avec flasques / con tapetas          | <b>22-8M-20</b>   | 90020022T                           | 5F  | FL053   | 1008   | 25     | 56,02  | 54,65  | 60,0  | -   | 37  | 28 | 22   | 6  | 0,25 |
|  |  | <b>24 8M 20</b>   | 90020024T                           | 5F  | FL069   | 1108   | 25     | 61,12  | 59,75  | 66,0  | -   | 44  | 28 | 22   | 6  | 0,30 |
|  |  | <b>26 8M 20</b>   | 90020026T                           | 5F  | FL061   | 1108   | 25     | 66,21  | 64,84  | 70,0  | -   | 45  | 28 | 22   | 6  | 0,36 |
|  |  | <b>28 8M 20</b>   | 90020028T                           | 5F  | FL079   | 1108   | 25     | 71,30  | 69,93  | 75,0  | -   | 50  | 28 | 22   | 6  | 0,44 |
|  |  | <b>30 8M 20</b>   | 90020030T                           | 5F  | FL073   | 1108   | 25     | 76,39  | 75,02  | 83,0  | -   | 58  | 28 | 22   | 6  | 0,53 |
|  |  | <b>32 8M 20</b>   | 90020032T                           | 5F  | FL076   | 1610   | 42     | 81,49  | 80,16  | 87,0  | -   | 63  | 28 | 25   | 3  | 0,42 |
|  |  | <b>34 8M 20</b>   | 90020034T                           | 5F  | FL066   | 1610   | 42     | 86,58  | 85,22  | 91,0  | -   | 64  | 28 | 25   | 3  | 0,55 |
|  |  | <b>36 8M 20</b>   | 90020036T                           | 5F  | FL068   | 1610   | 42     | 91,67  | 90,30  | 97,0  | -   | 68  | 28 | 25   | 3  | 0,68 |
|  |  | <b>38 8M 20</b>   | 90020038T                           | 5F  | FL070   | 1610   | 42     | 96,77  | 95,39  | 102,0 | -   | 72  | 28 | 25   | 3  | 0,80 |
|  |  | <b>40 8M 20</b>   | 90020040T                           | 5F  | FL077   | 1610   | 42     | 101,86 | 100,49 | 106,0 | -   | 76  | 28 | 25   | 3  | 1,00 |
|  |  | <b>44 8M 20</b>   | 90020044T                           | 8F  | FL075   | 2012   | 50     | 112,05 | 110,67 | 120,0 | 93  | -   | 28 | 32   | 4  | 1,20 |
|  |  | <b>48 8M 20</b>   | 90020048T                           | 8F  | FL078   | 2012   | 50     | 122,23 | 120,86 | 128,0 | 96  | -   | 28 | 32   | 4  | 1,60 |
|  |  | <b>56 8M 20</b>   | 90020056T                           | 8F  | FL085   | 2012   | 50     | 142,60 | 141,23 | 150,0 | 110 | -   | 28 | 32   | 4  | 2,40 |
|  |  | <b>64 8M 20</b>   | 90020064T                           | 8F  | FL090   | 2012   | 50     | 162,97 | 161,60 | 168,0 | 110 | 137 | 28 | 32   | 4  | 2,70 |
| <b>72 8M 20</b>  | 90020072T  | 8F  | FL097                               | 2012  | 50  | 183,35   | 181,97 | 192,0  | 110    | 158   | 28  | 32  | 4  | 3,30 |  |      |
| Ghisa / Cast iron<br>Grauguss / Fonte<br>Hierro fundido    | senza flangia / without flanges<br>ohne Flanschen / sans flasques<br>sin tapetas | <b>80 8M 20</b>   | 90020080T                           | 8W  | -   | 2012   | 50     | 203,72 | 202,35 | -     | 110 | 180 | 28 | 32   | 4  | 3,50 |
|  |  | <b>90 8M 20</b>   | 90020090T                           | 8A  | -   | 2012   | 50     | 229,18 | 227,81 | -     | 110 | 204 | 28 | 32   | 4  | 3,65 |
|  |  | <b>144 8M 20</b>  |                                     | 8A  | -   | 2517   | 60     | 366,69 | 365,32 | -     | 125 | 336 | 28 | 45   | 17   | 4,80 |

## HTD® 8M-30

| Caratteristiche<br>Features<br>Merkmale<br>Características | Codice<br>Code symbol<br>Bezeichnung<br>Code symbole<br>Numero de fabrica        | Nostro codice<br>Our code<br>Unser Code<br>Notre code<br>Nuestro codigo | Tipo<br>Type<br>Typ<br>Type<br>Tipo | Codice flangia<br>Flange code<br>Bordscheiben Typ<br>Code flasque<br>Código brida | Bussola<br>Bush<br>Buchse<br>Moyeu<br>Casquillo | Foro max.<br>Max. Bore<br>Max. Bohrung<br>Alesage max.<br>Agujero max. | Dp     | De     | Df     | Dm    | Di  | F   | S  | R    | Peso<br>Weight / Gewicht<br>Poids / Peso<br>Kg |      |
|--|--|---|-------------------------------------|---|---|--|--------|--------|--------|-------|-----|-----|----|------|--|------|
| Acciaio / Steel / Stahl<br>Acier / Acero                   | con flangia / with flanges<br>mit Flanges / avec flasques / con tapetas          | <b>22 8M 30</b>   | 90030022T                           | 5F  | FL053   | 1008   | 25     | 56,02  | 54,65  | 60,0  | -   | 37  | 38 | 22   | 16   | 0,31 |
|  |  | <b>24 8M 30</b>   | 90030024T                           | 5F  | FL069   | 1108   | 25     | 61,12  | 59,75  | 66,0  | -   | 44  | 38 | 22   | 16   | 0,38 |
|  |  | <b>26 8M 30</b>   | 90030026T                           | 5F  | FL061   | 1108   | 25     | 66,21  | 64,84  | 70,0  | -   | 44  | 38 | 22   | 16   | 0,45 |
|  |  | <b>28 8M 30</b>   | 90030028T                           | 5F  | FL079   | 1210   | 32     | 71,30  | 69,93  | 75,0  | -   | 50  | 38 | 25   | 13   | 0,50 |
|  |  | <b>30 8M 30</b>   | 90030030T                           | 3F  | FL073   | 1615   | 42     | 76,39  | 75,02  | 83,0  | -   | -   | 38 | 38   | -  | 0,55 |
|  |  | <b>32 8M 30</b>   | 90030032T                           | 3F  | FL076   | 1615   | 42     | 81,49  | 80,16  | 87,0  | -   | -   | 38 | 38   | -  | 0,59 |
|  |  | <b>34 8M 30</b>   | 90030034T                           | 3F  | FL066   | 1615   | 42     | 86,58  | 85,22  | 91,0  | -   | -   | 38 | 38   | -  | 0,77 |
|  |  | <b>36 8M 30</b>   | 90030036T                           | 3F  | FL068   | 1615   | 42     | 91,67  | 90,30  | 97,0  | -   | -   | 38 | 38   | -  | 0,96 |
|  |  | <b>38 8M 30</b>   | 90030038T                           | 3F  | FL070   | 1615   | 42     | 96,77  | 95,39  | 102,0 | -   | -   | 38 | 38   | -  | 1,15 |
|  |  | <b>40 8M 30</b>   | 90030040T                           | 3F  | FL077   | 1615   | 42     | 101,86 | 100,49 | 106,0 | -   | -   | 38 | 38   | -  | 1,34 |
|  |  | <b>44 8M 30</b>   | 90030044T                           | 4F  | FL075   | 2012   | 50     | 112,05 | 110,67 | 120,0 | -   | 86  | 38 | 32   | 3  | 1,33 |
|  |  | <b>48 8M 30</b>   | 90030048T                           | 4F  | FL078   | 2012   | 50     | 122,23 | 120,86 | 128,0 | -   | 90  | 38 | 32   | 3  | 1,78 |
|  |  | <b>56 8M 30</b>   | 90030056T                           | 4F  | FL085   | 2012   | 50     | 142,60 | 141,23 | 150,0 | -   | 110 | 38 | 32   | 3  | 3,76 |
|  |  | <b>64 8M 30</b>   | 90030064T                           | 8F  | FL090   | 2517   | 60     | 162,97 | 161,60 | 168,0 | 125 | -   | 38 | 45   | 7  | 4,20 |
| <b>72 8M 30</b>  | 90030072T  | 8F  | FL097                               | 2517  | 60  | 183,35   | 181,97 | 192,0  | 125    | 158   | 38  | 45  | 7  | 4,30 |  |      |
| Ghisa / Cast iron<br>Grauguss / Fonte<br>Hierro fundido    | senza flangia / without flanges<br>ohne Flanschen / sans flasques<br>sin tapetas | <b>80 8M 30</b>   | 90030080T                           | 8W  | -   | 2517   | 60     | 203,72 | 202,35 | -     | 125 | 180 | 38 | 45   | 7  | 4,60 |
|  |  | <b>90 8M 30</b>   | 90030090T                           | 8A  | -   | 2517   | 60     | 229,18 | 227,81 | -     | 125 | 204 | 38 | 45   | 7  | 5,00 |
|  |  | <b>112 8M 30</b>  | 90030112T                           | 8A  | -   | 2517   | 60     | 285,21 | 283,83 | -     | 125 | 254 | 38 | 45   | 7  | 6,20 |
|  |  | <b>144 8M 30</b>  | 90030144T                           | 8A  | -   | 2517   | 60     | 366,69 | 365,32 | -     | 125 | 336 | 38 | 45   | 7  | 9,00 |



## HTD® 8M-50

| Caratteristiche<br>Features<br>Merkmal<br>Características | Codice<br>Code symbol<br>Bezeichnung<br>Code symbole<br>Numero de fabrica        | Nostro codice<br>Our code<br>Unser Code<br>Notre code<br>Nuestro codiglo | Tipo<br>Type<br>Typ<br>Type<br>Tipo | Codice flangia<br>Flange code<br>Bordscheiben Typ<br>Code flasque<br>Código brida | Bussola<br>Bush<br>Buchse<br>Moyeu<br>Casquillo | Foro max.<br>Max. Bore<br>Max. Bohrung<br>Alesage max.<br>Agujero max. | Dp     | De     | Df    | Dm  | Di  | F   | S    | R    | Peso<br>Weight / Gewicht<br>Poids / Peso<br>Kg |
|---|--|--|-------------------------------------|---|---|--|--------|--------|-------|-----|-----|-----|------|------|--|
| Acciaio / Steel / Stahl<br>Acier / Acero                  | con flangia / with flanges<br>mit Flanges / avec flasques / con tapetas          | <b>28 8M 50</b>  | 4F                                  | FL079   | 1210  | 32   | 71,30  | 69,93  | 75,0  | -   | 50  | 60  | 25   | 17,5 | 0,60   |
|   |  | <b>30 8M 50</b>  | 5F                                  | FL073   | 1615  | 42   | 76,39  | 75,02  | 83,0  | -   | 58  | 60  | 38   | 22,0 | 0,65   |
|   |  | <b>32 8M 50</b>  | 5F                                  | FL076   | 1615  | 42   | 81,49  | 80,16  | 87,0  | -   | 62  | 60  | 38   | 22,0 | 0,82   |
|   |  | <b>34 8M 50</b>  | 5F                                  | FL066   | 1615  | 42   | 86,58  | 85,22  | 91,0  | -   | 65  | 60  | 38   | 22,0 | 1,06   |
|   |  | <b>36 8M 50</b>  | 5F                                  | FL068   | 1615  | 42   | 91,67  | 90,30  | 97,0  | -   | 68  | 60  | 38   | 22,0 | 1,30   |
|   |  | <b>38 8M 50</b>  | 5F                                  | FL070   | 1615  | 42   | 96,77  | 95,39  | 102,0 | -   | 72  | 60  | 38   | 22,0 | 1,60   |
|   |  | <b>40 8M 50</b>  | 4F                                  | FL077   | 2012  | 50   | 101,86 | 100,49 | 106,0 | -   | 82  | 60  | 32   | 14,0 | 1,71   |
|   |  | <b>44 8M 50</b>  | 4F                                  | FL075   | 2012  | 50   | 112,05 | 110,67 | 120,0 | -   | 91  | 60  | 32   | 14,0 | 1,78   |
|   |  | <b>48 8M 50</b>  | 4F                                  | FL078   | 2012  | 50   | 122,23 | 120,86 | 128,0 | -   | 95  | 60  | 32   | 14,0 | 2,30   |
|   |  | <b>56 8M 50</b>  | 4F                                  | FL085   | 2517  | 60   | 142,60 | 141,23 | 150,0 | -   | 116 | 60  | 45   | 7,5  | 3,40   |
|   |  | <b>64 8M 50</b>  | 4F                                  | FL090   | 2517  | 60   | 162,97 | 161,60 | 168,0 | -   | 137 | 60  | 45   | 7,5  | 5,00   |
| <b>72 8M 50</b>   | 9WF  | FL097  | 2517                                | 60  | 183,35  | 181,97   | 192,0  | 125    | 158   | 60  | 45  | 7,5 | 6,70 |      |  |
| Ghisa / Cast iron<br>Grauguss / Fonte<br>Hierro fundido   | senza flangia / without flanges<br>ohne Flanschen / sans flasques<br>sin tapetas | <b>80 8M 50</b>  | 4                                   | -   | 3020  | 75   | 203,72 | 202,35 | -     | -   | 180 | 60  | 51   | 4,5  | 8,80   |
|   |  | <b>90 8M 50</b>  | 9W                                  | -   | 3020  | 75   | 229,18 | 227,81 | -     | 170 | 204 | 60  | 51   | 4,5  | 10,00  |
|   |  | <b>112 8M 50</b>   | 9W                                  | -   | 3020  | 75   | 285,21 | 283,83 | -     | 170 | 260 | 60  | 51   | 4,5  | 12,00  |
|   |  | <b>144 8M 50</b>   | 9A                                  | -   | 3020  | 75   | 366,69 | 365,32 | -     | 170 | 341 | 60  | 51   | 4,5  | 15,20  |
|   |  | <b>168 8M 50</b>   | 7A                                  | -   | 3525  | 90   | 427,81 | 426,44 | -     | 198 | 395 | 60  | 65   | 2,5  | 17,50  |
|   |  | <b>192 8M 50</b>   | 7A                                  | -   | 3525  | 90   | 488,92 | 487,55 | -     | 198 | 455 | 60  | 65   | 2,5  | 24,00  |

## HTD® 8M-85

| Caratteristiche<br>Features<br>Merkmal<br>Características | Codice<br>Code symbol<br>Bezeichnung<br>Code symbole<br>Numero de fabrica        | Nostro codice<br>Our code<br>Unser Code<br>Notre code<br>Nuestro codiglo | Tipo<br>Type<br>Typ<br>Type<br>Tipo | Codice flangia<br>Flange code<br>Bordscheiben Typ<br>Code flasque<br>Código brida | Bussola<br>Bush<br>Buchse<br>Moyeu<br>Casquillo | Foro max.<br>Max. Bore<br>Max. Bohrung<br>Alesage max.<br>Agujero max. | Dp     | De     | Df    | Dm  | Di  | F    | S    | R    | Peso<br>Weight / Gewicht<br>Poids / Peso<br>Kg |
|---|--|--|-------------------------------------|---|---|--|--------|--------|-------|-----|-----|------|------|------|--|
| Acciaio / Steel / Stahl<br>Acier / Acero                  | con flangia / with flanges<br>mit Flanges / avec flasques / con tapetas          | <b>34 8M 85</b>  | 4F                                  | FL066   | 1615  | 42   | 86,58  | 85,22  | 91,0  | -   | 65  | 95   | 38   | 28,5 | 1,43   |
|   |  | <b>36 8M 85</b>  | 4F                                  | FL068   | 1615  | 42   | 91,67  | 90,30  | 97,0  | -   | 68  | 95   | 38   | 28,5 | 1,87   |
|   |  | <b>38 8M 85</b>  | 4F                                  | FL070   | 1615  | 42   | 96,77  | 95,39  | 102,0 | -   | 72  | 95   | 38   | 28,5 | 2,20   |
|   |  | <b>40 8M 85</b>  | 4F                                  | FL077   | 2012  | 50   | 101,86 | 100,49 | 106,0 | -   | 82  | 95   | 32   | 31,5 | 1,80   |
|   |  | <b>44 8M 85</b>  | 4F                                  | FL075   | 2012  | 50   | 112,05 | 110,67 | 120,0 | -   | 91  | 95   | 32   | 31,5 | 2,30   |
|   |  | <b>48 8M 85</b>  | 4F                                  | FL078   | 2517  | 60   | 122,23 | 120,86 | 128,0 | -   | 100 | 95   | 45   | 25,0 | 2,66   |
|   |  | <b>56 8M 85</b>  | 4F                                  | FL085   | 2517  | 60   | 142,60 | 141,23 | 150,0 | -   | 117 | 95   | 45   | 25,0 | 4,45   |
|   |  | <b>64 8M 85</b>  | 4F                                  | FL090   | 2517  | 60   | 162,97 | 161,60 | 168,0 | -   | 137 | 95   | 45   | 25,0 | 6,20   |
| <b>72 8M 85</b>   | 4F   | FL097  | 3020                                | 75  | 183,35  | 181,97   | 192,0  | -      | 158   | 95  | 51  | 22,0 | 8,00 |      |  |
| Ghisa / Cast iron<br>Grauguss / Fonte<br>Hierro fundido   | senza flangia / without flanges<br>ohne Flanschen / sans flasques<br>sin tapetas | <b>80 8M 85</b>  | 4                                   | -   | 3020  | 75   | 203,72 | 202,35 | -     | -   | 180 | 95   | 51   | 22,0 | 10,00  |
|   |  | <b>90 8M 85</b>  | 9W                                  | -   | 3020  | 75   | 229,18 | 227,81 | -     | 170 | 204 | 95   | 51   | 22,0 | 10,80  |
|   |  | <b>112 8M 85</b>   | 9W                                  | -   | 3020  | 75   | 285,21 | 283,83 | -     | 170 | 260 | 95   | 51   | 22,0 | 15,00  |
|   |  | <b>144 8M 85</b>   | 9A                                  | -   | 3525  | 90   | 366,69 | 365,32 | -     | 198 | 336 | 95   | 65   | 15,0 | 20,00  |
|   |  | <b>168 8M 85</b>   | 9A                                  | -   | 3525  | 90   | 427,81 | 426,44 | -     | 198 | 395 | 95   | 65   | 15,0 | 22,00  |
|   |  | <b>192 8M 85</b>   | 9A                                  | -   | 3525  | 90   | 488,92 | 487,55 | -     | 198 | 455 | 95   | 65   | 15,0 | 26,00  |