

Tipo / Type
6F

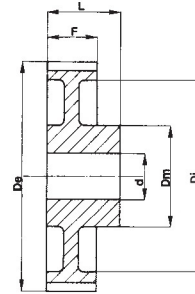

Tipo / Type
6W

HTD® 5M-09

Caratteristiche Features Merkmal Características	Codice Code symbol Bezeichnung Code symbole Numero de fabrica	Nostro codice Our code Unser Code Notre code Nuestro codigo	Tipo Type Typ Type Tipo	Codice flangia Flange code Bordscheiben Typ Code flasque Código brida	N. denti N. of teeth Zähnezahl N. bre de dents Cantidad de dientes	Dp	De	Df	Dm	Di	F	L	Foro stock Stock bore Vor bohrung Alesage en stock Agujero de stock	Peso Weight / Gewicht Poids / Peso Kg
Acciaio / Steel / Stahl Acier / Acero con flangia / with flanges mit Flanges / avec flasques con tapetas	12 5M 09	90009012	6F	FL014	12	19,10	17,96	23,0	12,0	-	14,5	20,0	4	0,028
	14 5M 09	90009014	6F	FL002	14	22,28	21,14	25,0	13,0	-	14,5	20,0	6	0,034
	15 5M 09	90009015	6F	FL004	15	23,87	22,73	28,0	16,0	-	14,5	20,0	6	0,042
	16 5M 09	90009016	6F	FL004	16	25,46	24,32	28,0	16,5	-	14,5	20,0	6	0,050
	18 5M 09	90009018	6F	FL006	18	28,65	27,51	32,0	20,0	-	14,5	20,0	6	0,070
	20 5M 09	90009020	6F	FL008	20	31,83	30,69	36,0	23,0	-	14,5	22,5	6	0,094
	21 5M 09	90009021	6F	FL009	21	33,42	32,28	38,0	24,0	-	14,5	22,5	6	0,110
	22 5M 09	90009022	6F	FL015	22	35,01	33,87	39,0	25,5	-	14,5	22,5	6	0,118
	24 5M 09	90009024	6F	FL013	24	38,20	37,06	42,0	27,0	-	14,5	22,5	6	0,145
	26 5M 09	90009026	6F	FL012	26	41,38	40,24	44,0	30,0	-	14,5	22,5	6	0,170
	28 5M 09	90009028	6F	FL011	28	44,56	43,42	48,0	30,5	-	14,5	22,5	6	0,200
	30 5M 09	90009030	6F	FL016	30	47,75	46,60	51,0	35,0	-	14,5	22,5	6	0,236
	32 5M 09	90009032	6F	FL018	32	50,93	49,79	54,0	38,0	-	14,5	22,5	8	0,210
	36 5M 09	90009036	6F	FL021	36	57,30	56,16	60,0	38,0	-	14,5	22,5	8	0,324
40 5M 09	90009040	6F	FL025	40	63,66	62,52	71,0	38,0	-	14,5	22,5	8	0,400	
Alluminio / Aluminium Aluminium / Aluminium Aluminio senza flangia / without flanges / ohne Flanschen sans flasques / sin tapetas	44 5M 09	90009044	6W	-	44	70,03	68,89	-	38,0	54	14,5	25,5	8	0,170
	48 5M 09	90009048	6W	-	48	76,39	75,25	-	45,0	61	14,5	25,5	8	0,182
	60 5M 09	90009060	6W	-	60	95,46	94,35	-	45,0	80	14,5	25,5	8	0,230
	72 5M 09	90009072	6W	-	72	114,59	113,45	-	45,0	100	14,5	25,5	8	0,270



HTD® 5M-15

Caratteristiche Features Merkmale Características	Codice Code symbol Bezeichnung Code symbole Numero de fabrica	Nostro codice Our code Unser Code Notre code Nuestro codigo	Tipo Type Typ Type Tipo	Codice flangia Flange code Bordscheiben Typ Code flasque Código brida	N. denti N. of teeth Zähnezahl N. bre de dents Cantidad de dientes	Dp	De	Df	Dm	Di	F	L	Foro stock Stock bore Vor bohrung Alesage en stock Agujero de stock	Peso Weight / Gewicht Poids / Peso Kg
Acciaio / Steel / Stahl Acier / Acero con flangia / with flanges mit Flanges / avec flasques con tapetas	12 5M 15	90015012	6F	FL014	12	19,10	17,96	23,0	12,0	-	20,5	26,0	4	0,034
	14 5M 15	90015014	6F	FL002	14	22,28	21,14	25,0	13,0	-	20,5	26,0	6	0,046
	15 5M 15	90015015	6F	FL004	15	23,87	22,73	28,0	16,0	-	20,5	26,0	6	0,056
	16 5M 15	90015016	6F	FL004	16	25,46	24,32	28,0	16,5	-	20,5	26,0	6	0,064
	18 5M 15	90015018	6F	FL006	18	28,65	27,51	32,0	20,0	-	20,5	26,0	6	0,086
	20 5M 15	90015020	6F	FL008	20	31,83	30,69	36,0	23,0	-	20,5	26,0	6	0,112
	21 5M 15	90015021	6F	FL009	21	33,42	32,28	38,0	24,0	-	20,5	26,0	6	0,130
	22 5M 15	90015022	6F	FL015	22	35,01	33,87	39,0	25,5	-	20,5	26,0	6	0,140
	24 5M 15	90015024	6F	FL013	24	38,20	37,06	42,0	27,0	-	20,5	28,0	6	0,180
	26 5M 15	90015026	6F	FL012	26	41,38	40,24	44,0	30,0	-	20,5	28,0	6	0,220
	28 5M 15	90015028	6F	FL011	28	44,56	43,42	48,0	30,5	-	20,5	28,0	6	0,250
	30 5M 15	90015030	6F	FL016	30	47,75	46,60	51,0	35,0	-	20,5	28,0	6	0,300
	32 5M 15	90015032	6F	FL018	32	50,93	49,79	54,0	38,0	-	20,5	28,0	8	0,350
	36 5M 15	90015036	6F	FL021	36	57,30	56,16	60,0	38,0	-	20,5	28,0	8	0,426
40 5M 15	90015040	6F	FL025	40	63,66	62,52	71,0	38,0	-	20,5	28,0	8	0,520	
Alluminio / Aluminium Aluminium / Aluminium Aluminio senza flangia / without flanges / ohne Flanschen sans flasques / sin tapetas	44 5M 15	90015044	6W	-	44	70,03	68,89	-	38,0	54	20,5	30,0	8	0,225
	48 5M 15	90015048	6W	-	48	76,39	75,25	-	45,0	61	20,5	30,0	8	0,187
	60 5M 15	90015060	6W	-	60	95,46	94,35	-	45,0	80	20,5	30,0	8	0,305
	72 5M 15	90015072	6W	-	72	114,59	113,45	-	45,0	100	20,5	30,0	8	0,305

HTD® 5M-25

Caratteristiche Features Merkmale Características	Codice Code symbol Bezeichnung Code symbole Numero de fabrica	Nostro codice Our code Unser Code Notre code Nuestro codigo	Tipo Type Typ Type Tipo	Codice flangia Flange code Bordscheiben Typ Code flasque Código brida	N. denti N. of teeth Zähnezahl N. bre de dents Cantidad de dientes	Dp	De	Df	Dm	Di	F	L	Foro stock Stock bore Vor bohrung Alesage en stock Agujero de stock	Peso Weight / Gewicht Poids / Peso Kg
Acciaio / Steel / Stahl Acier / Acero con flangia / with flanges mit Flanges / avec flasques con tapetas	12 5M 25	90025012	6F	FL014	12	19,10	17,96	23,0	12,0	-	30,5	36,0	4	0,050
	14 5M 25	90025014	6F	FL002	14	22,28	21,14	25,0	13,0	-	30,5	36,0	6	0,070
	15 5M 25	90025015	6F	FL004	15	23,87	22,73	28,0	16,0	-	30,5	36,0	6	0,080
	16 5M 25	90025016	6F	FL004	16	25,46	24,32	28,0	16,5	-	30,5	36,0	6	0,100
	18 5M 25	90025018	6F	FL006	18	28,65	27,51	32,0	20,0	-	30,5	36,0	6	0,120
	20 5M 25	90025020	6F	FL008	20	31,83	30,69	36,0	23,0	-	30,5	36,0	6	0,160
	21 5M 25	90025021	6F	FL009	21	33,42	32,28	38,0	24,0	-	30,5	38,5	6	0,190
	22 5M 25	90025022	6F	FL015	22	35,01	33,87	39,0	25,5	-	30,5	38,5	6	0,210
	24 5M 25	90025024	6F	FL013	24	38,20	37,06	42,0	27,0	-	30,5	38,5	6	0,250
	26 5M 25	90025026	6F	FL012	26	41,38	40,24	44,0	30,0	-	30,5	38,5	6	0,300
	28 5M 25	90025028	6F	FL011	28	44,56	43,42	48,0	30,5	-	30,5	38,5	6	0,350
	30 5M 25	90025030	6F	FL016	30	47,75	46,60	51,0	35,0	-	30,5	38,5	6	0,420
	32 5M 25	90025032	6F	FL018	32	50,93	49,79	54,0	38,0	-	30,5	38,5	8	0,480
	36 5M 25	90025036	6F	FL021	36	57,30	56,16	60,0	38,0	-	30,5	38,5	8	0,590
40 5M 25	90025040	6F	FL025	40	63,66	62,52	71,0	38,0	-	30,5	38,5	8	0,740	
Alluminio / Aluminium Aluminium / Aluminium Aluminio senza flangia / without flanges / ohne Flanschen sans flasques / sin tapetas	44 5M 25	90025044	6W	-	44	70,03	68,89	-	38,0	54	30,5	40,5	8	0,320
	48 5M 25	90025048	6W	-	48	76,39	75,25	-	45,0	61	30,5	40,5	8	0,275
	60 5M 25	90025060	6W	-	60	95,46	94,35	-	45,0	80	30,5	40,5	8	0,435
	72 5M 25	90025072	6W	-	72	114,59	113,45	-	45,0	100	30,5	40,5	8	0,525