



Materiale:
alluminio 6082 T6
UNI 9006/4 adatto al
trattamento anodico

Material:
aluminium 6082 T6
UNI 9006/4 suitable for
anodic treatment

Werkstoff:
Aluminium 6082 T6
UNI 9006/4 geeignet für
anodischen oxydation

Matière:
aluminium 6082 T6
UNI 9006/4 apte au
traitement anodique

Material:
aluminio 6082 T6
UNI 9006/4 apto para la
oxidacion anodica

Tipo / Type
6F

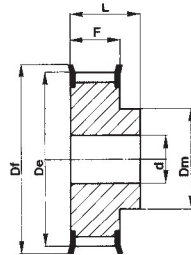

Tipo / Type
6

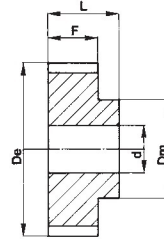

T 10

(Paso 10 mm)
per cinghia larghezza 16 mm

(Pitch 10 mm)
for belt width 16 mm

(Teilung 10 mm)
für Riemenbreite 16 mm

(Pas 10 mm)
pour courroies largeur 16 mm

(Paso 10 mm)
para correas ancho 16 mm

Codice Code symbol / Bezeichnung Code symbole / Numero de fabrica	Nostro codice Our code / Unser Code Notre code / Nuestro codigo	Tipo Type / Typ Type / Tipo	Codice flangia Flange code / Bordscheiben Typ Code flasque / Código brida	N. denti N. of teeth / Zahnzahl N. bre de dents / Cantidad de dientes	Dp	De	Df	Dm	F	L	d	Peso / Weight Gewicht / Poids / Peso Kg
31T10/12-2	93110012	6F	FL013	12	38,20	36,35	42,0	28	21	31	6	0,076
31T10/14-2	93110014	6F	FL011	14	44,56	42,70	48,0	32	21	31	8	0,104
31T10/15-2	93110015	6F	FL016	15	47,75	45,90	51,0	32	21	31	8	0,116
31T10/16-2	93110016	6F	FL018	16	50,93	49,10	54,0	35	21	31	8	0,134
31T10/18-2	93110018	6F	FL021	18	57,29	55,45	60,0	40	21	31	8	0,167
31T10/19-2	93110019	6F	FL024	19	60,48	58,65	66,5	44	21	31	8	0,184
31T10/20-2	93110020	6F	FL024	20	63,66	61,80	66,5	46	21	31	8	0,208
31T10/22-2	93110022	6F	FL027	22	70,03	68,20	75,0	52	21	31	8	0,240
31T10/24-2	93110024	6F	FL029	24	76,39	74,55	83,0	58	21	31	8	0,288
31T10/25-2	93110025	6F	FL029	25	79,58	77,70	83,0	60	21	31	8	0,295
31T10/26-2	93110026	6F	FL031	26	82,76	80,90	87,0	60	21	31	8	0,310
31T10/27-2	93110027	6F	FL032	27	85,95	84,10	91,0	60	21	31	8	0,364
31T10/28-2	93110028	6F	FL033	28	89,12	87,25	93,0	60	21	31	8	0,441
31T10/30-2	93110030	6F	FL035	30	95,49	93,65	97,0	60	21	31	8	0,493
31T10/32-2	93110032	6F	FL038	32	101,86	100,00	106,0	65	21	31	10	0,623
31T10/36-2	93110036	6F	FL043	36	114,59	112,75	119,0	70	21	31	10	0,767
31T10/40-2	93110040	6F	FL047	40	127,32	125,45	131,0	80	21	31	10	0,950
31T10/44-0	93110044	6	-	44	140,05	138,20	-	88	21	31	10	1,090
31T10/48-0	93110048	6	-	48	152,78	150,95	-	95	21	31	16	1,704
31T10/60-0	93110060	6	-	60	190,98	189,10	-	110	21	31	16	1,704

(Paso 10 mm)
per cinghia larghezza 25 mm

(Pitch 10 mm)
for belt width 25 mm

(Teilung 10 mm)
für Riemenbreite 25 mm

(Pas 10 mm)
pour courroies largeur 25 mm

(Paso 10 mm)
para correas ancho 25 mm

Codice Code symbol / Bezeichnung Code symbole / Numero de fabrica	Nostro codice Our code / Unser Code Notre code / Nuestro codigo	Tipo Type / Typ Type / Tipo	Codice flangia Flange code / Bordscheiben Typ Code flasque / Código brida	N. denti N. of teeth / Zahnzahl N. bre de dents / Cantidad de dientes	Dp	De	Df	Dm	F	L	d	Peso / Weight Gewicht / Poids / Peso Kg
40T10/12-2	94010012	6F	FL013	12	38,20	36,35	42,0	28	30	40	6	0,099
40T10/14-2	94010014	6F	FL011	14	44,56	42,70	48,0	32	30	40	8	0,134
40T10/15-2	94010015	6F	FL016	15	47,75	45,90	51,0	32	30	40	8	0,152
40T10/16-2	94010016	6F	FL018	16	50,93	49,10	54,0	35	30	40	8	0,176
40T10/18-2	94010018	6F	FL021	18	57,29	55,45	60,0	40	30	40	8	0,224
40T10/19-2	94010019	6F	FL024	19	60,48	58,65	66,5	44	30	40	8	0,247
40T10/20-2	94010020	6F	FL024	20	63,66	61,80	66,5	46	30	40	8	0,276
40T10/22-2	94010022	6F	FL027	22	70,03	68,20	75,0	52	30	40	8	0,310
40T10/24-2	94010024	6F	FL029	24	76,39	74,55	83,0	58	30	40	8	0,392
40T10/25-2	94010025	6F	FL029	25	79,58	77,70	83,0	60	30	40	8	0,422
40T10/26-2	94010026	6F	FL031	26	82,76	80,90	87,0	60	30	40	8	0,480
40T10/27-2	94010027	6F	FL032	27	85,95	84,10	91,0	60	30	40	8	0,536
40T10/28-2	94010028	6F	FL033	28	89,12	87,25	93,0	60	30	40	8	0,590
40T10/30-2	94010030	6F	FL035	30	95,49	93,65	97,0	60	30	40	8	0,640
40T10/32-2	94010032	6F	FL038	32	101,86	100,00	106,0	65	30	40	10	0,693
40T10/36-2	94010036	6F	FL043	36	114,59	112,75	119,0	70	30	40	10	0,873
40T10/40-2	94010040	6F	FL047	40	127,32	125,45	131,0	80	30	40	10	1,067
40T10/44-0	94010044	6	-	44	140,05	138,20	-	88	30	40	10	1,310
40T10/48-0	94010048	6	-	48	152,78	150,95	-	95	30	40	16	1,516
40T10/60-0	94010060	6	-	60	190,98	189,10	-	110	30	40	16	2,339



Materiale:
alluminio 6082 T6
UNI 9006/4 adatto al
trattamento anodico

Material:
aluminium 6082 T6 UNI
9006/4 suitable for anodic
treatment

Werkstoff:
Aluminium 6082 T6
UNI 9006/4 geeignet für
anodischen oxydation

Matière:
aluminium 6082 T6
UNI 9006/4 apte au
traitement anodique

Material:
aluminio 6082 T6
UNI 9006/4 apto para la
oxidacion anodica

Tipo / Type
6F

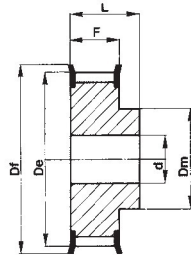

Tipo / Type
6

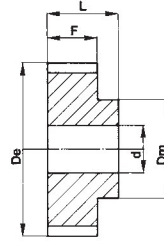

T 10

(Paso 10 mm)
per cinghia larghezza 32 mm

(Pitch 10 mm)
for belt width 32 mm

(Teilung 10 mm)
für Riemenbreite 32 mm

(Pas 10 mm)
pour courroies largeur 32 mm

(Paso 10 mm)
para correas ancho 32 mm

Codice Code symbol / Bezeichnung Code symbole / Numero de fabrica	Nostro codice Our code / Unser Code Notre code / Nuestro codigo	Tipo Type / Typ Type / Tipo	Codice flangia Flange code / Bordscheiben Typ Code flasque / Código brida	N. denti N. of teeth / Zähnezahl N. bre de dents / Cantidad de dientes	Dp	De	Df	Dm	F	L	d	Peso / Weight Gewicht / Poids / Peso Kg
47T10/18-2	94710018	6F	FL021	18	57,29	55,45	60,0	40	37	47	10	0,253
47T10/19-2	94710019	6F	FL024	19	60,48	58,65	66,5	44	37	47	10	0,286
47T10/20-2	94710020	6F	FL024	20	63,66	61,80	66,5	46	37	47	12	0,322
47T10/22-2	94710022	6F	FL027	22	70,03	68,20	75,0	52	37	47	12	0,393
47T10/24-2	94710024	6F	FL029	24	76,39	74,55	83,0	58	37	47	12	0,475
47T10/25-2	94710025	6F	FL029	25	79,58	77,70	83,0	60	37	47	12	0,527
47T10/26-2	94710026	6F	FL031	26	82,76	80,90	87,0	60	37	47	12	0,564
47T10/27-2	94710027	6F	FL032	27	85,95	84,10	91,0	60	37	47	12	0,602
47T10/28-2	94710028	6F	FL033	28	89,12	87,25	93,0	60	37	47	12	0,642
47T10/30-2	94710030	6F	FL035	30	95,49	93,65	97,0	60	37	47	12	0,740
47T10/32-2	94710032	6F	FL038	32	101,86	100,00	106,0	65	37	47	12	0,844
47T10/36-2	94710036	6F	FL043	36	114,59	112,75	119,0	70	37	47	16	1,063
47T10/40-2	94710040	6F	FL047	40	127,32	125,45	131,0	80	37	47	16	1,371
47T10/44-0	94710044	6	-	44	140,05	138,20	-	88	37	47	16	1,611
47T10/48-0	94710048	6	-	48	152,78	150,95	-	95	37	47	16	1,913
47T10/60-0	94710060	6	-	60	190,98	189,10	-	110	37	47	16	3,004

(Paso 10 mm)
per cinghia larghezza 50 mm

(Pitch 10 mm)
for belt width 50 mm

(Teilung 10 mm)
für Riemenbreite 50 mm

(Pas 10 mm)
pour courroies largeur 50 mm

(Paso 10 mm)
para correas ancho 50 mm

66T10/18-2	96610018	6F	FL021	18	57,29	55,45	60,0	40	56	66	10	0,422
66T10/19-2	96610019	6F	FL024	19	60,48	58,65	66,5	44	56	66	10	0,466
66T10/20-2	96610020	6F	FL024	20	63,66	61,80	66,5	46	56	66	12	0,520
66T10/22-2	96610022	6F	FL027	22	70,03	68,20	75,0	52	56	66	12	0,640
66T10/24-2	96610024	6F	FL029	24	76,39	74,55	83,0	58	56	66	12	0,736
66T10/25-2	96610025	6F	FL029	25	79,58	77,70	83,0	60	56	66	12	0,766
66T10/26-2	96610026	6F	FL031	26	82,76	80,90	87,0	60	56	66	12	0,845
66T10/27-2	96610027	6F	FL032	27	85,95	84,10	91,0	60	56	66	12	0,946
66T10/28-2	96610028	6F	FL033	28	89,12	87,25	93,0	60	56	66	12	0,110
66T10/30-2	96610030	6F	FL035	30	95,49	93,65	97,0	60	56	66	12	1,169
66T10/32-2	96610032	6F	FL038	32	101,86	100,00	106,0	65	56	66	12	1,300
66T10/36-2	96610036	6F	FL043	36	114,59	112,75	119,0	70	56	66	16	1,637
66T10/40-2	96610040	6F	FL047	40	127,32	125,45	131,0	80	56	66	16	1,999
66T10/44-0	96610044	6	-	44	140,05	138,20	-	88	56	66	16	2,420
66T10/48-0	96610048	6	-	48	152,78	150,95	-	95	56	66	16	2,830
66T10/60-0	96610060	6	-	60	190,98	189,10	-	110	56	66	16	4,366